

# AHMsys: An Automated HVAC Modeling System for BIM Project

Long Hoang Dang<sup>a,b,\*</sup>, Duy-Hung Nguyen<sup>a</sup>, Thai Quang Le<sup>a</sup>, Thinh Truong Nguyen<sup>a</sup>, Clark Mei<sup>a</sup> and Vu Hoang<sup>a</sup>

<sup>a</sup>Akila

<sup>b</sup>Posts and Telecommunications Institute of Technology

**Abstract.** This paper presents a novel system, named AHMsys, designed to automate the process of generating 3D Heating, Ventilation, and Air Conditioning (HVAC) models from 2D Computer-Aided Design (CAD) drawings, a key component of Building Information Modeling (BIM). By automatically preprocessing and extracting essential HVAC object information then creating detailed 3D models, our proposed AHMsys significantly reduced the 20% work schedule of the BIM process in Akila. This advancement highlights the essential impact of integrating AI technologies in managing the lifecycle of a building's digital representation.

## 1 Introduction

Building Information Modeling (BIM) is a comprehensive technology that involves the creation and maintenance of a digital representation (model) of a physical structure throughout its entire lifecycle, becoming crucial in the field of construction. This model is more than just a collection of geometric shapes; it includes detailed information about the components, properties, and spatial relationships of the objects in the building. Among its various aspects, Heating, Ventilation, and Air Conditioning (HVAC) modeling - the process that generate a 3D model from 2D Computer-Aided Design (CAD) drawings, stands out as a critical and often the most labor-intensive phase in a BIM project [11]. With the rapid development of Artificial Intelligence (AI), there is an urgent and real need in architectural and construction companies to develop a system that can fully automate the HVAC-modeling stage, which can improve project efficiency, reduce human labors and production costs, and enhancing market competitiveness.

Previous studies have frequently utilized deep learning models, including CNNs [7, 5, 9, 8], GAN [4], and Graph Neural Networks (GNNs) [6] to automate the extraction of information from CAD drawings. These approaches typically necessitate large amounts of annotated data for training and significant computational resources [3]. Unlike these approaches, our work looks into a lightweight system designed to be more accessible for the majority of architecture and construction companies, which often lack the extensive labeled data and machines available to larger entities. Furthermore, to the best of our knowledge, our project is the first to offer an automated solution that does not require extensive labeled data or significant computational resources, capable of directly converting 2D CAD

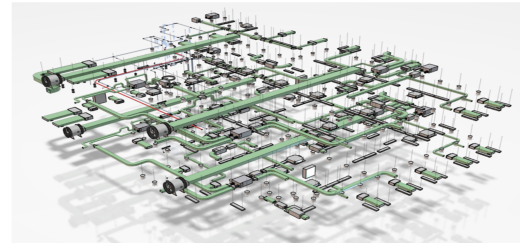
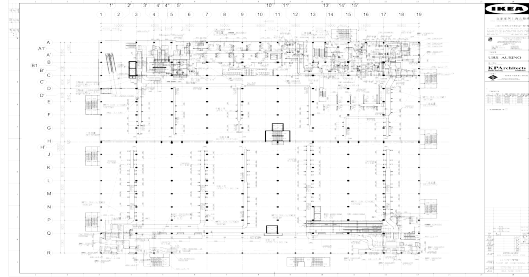

**Figure 1.** The 3D HVAC model generated by our proposed AHMsys based drawings into 3D HVAC models. Figure 1 illustrates a 3D model of an HVAC system generated by our proposed method.

In this paper, we introduce AHMsys: Automated HVAC Modeling System, designed to fully automate the HVAC modeling process within BIM projects. Our framework is structured around three principal phases: 1) 2D Drawing Preprocessing, 2) 2D HVAC Drawing extraction, and 3) 3D Model Generation. We have effectively developed and incorporated AI technologies that are well-suited for operations on a tight budget, making it suitable for small to medium-sized companies to adopt easily. AHMsys has been successfully implemented in Akila, a global firm offering ESG solutions for buildings and factories, where it has substantially reduced the work schedule 20% of BIM projects that were previously dependent on manual labor.

## 2 System Framework

We present an overview of our proposed AHMsys in Figure 2. This framework takes a 2D CAD drawing and a list of potential object types within the drawing as inputs, and produces an integrated 3D model as output. It is important to note that the primary objective of this work is to generate 3D models specifically for HVAC systems.

\* Corresponding Author. Email: long.dang@akila3d.com

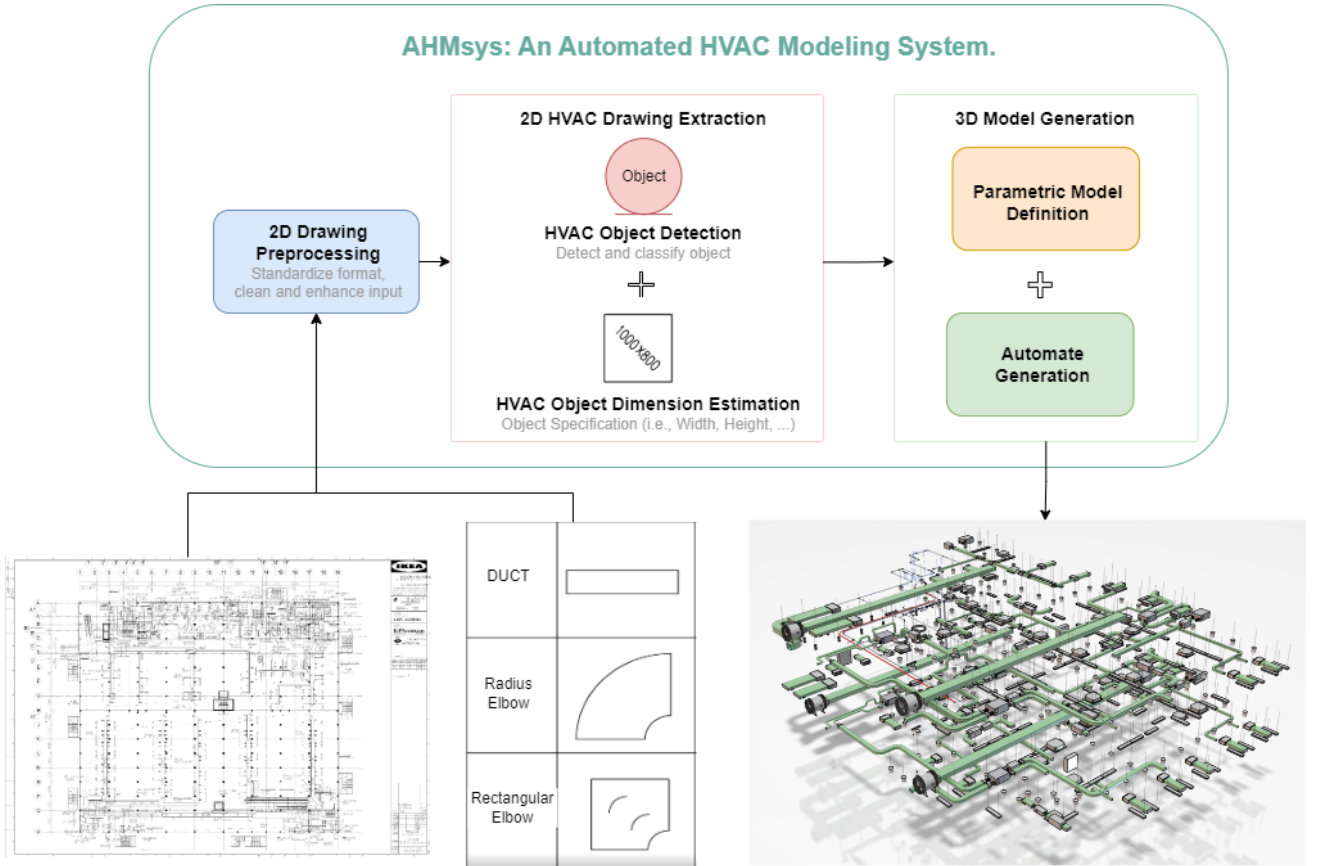

**Figure 2.** Our proposed AHMsys contains three key steps: 1) 2D Drawing Preprocessing, 2) 2D HVAC Drawing Extraction, and 3) 3D Model Generation. Given a 2D CAD drawing and a list of potential object types within the drawing as inputs, this framework will create integrated 3D HVAC model as output. As such, we preprocess the input by removing non-HVAC objects from the drawing. The workflow comprises several key steps: Firstly, drawings are exported from CAD software and undergo preprocessing to prepare them for subsequent analysis. Subsequently, the 2D HVAC Drawing Extraction module identifies and extracts essential information about each object, including its type, specifications, and spatial coordinates. Finally, the 3D Model Generation engine utilizes this extracted information to construct a comprehensive 3D model. Each component of this process will be discussed in further detail in the sections that follow.

### 2.1 2D Drawing Preprocessing

The objective of the data preprocessing step is to refine the drawings to a high standard of quality, thereby optimizing them for next analytical processes. Initially, 2D CAD drawings are cleansed of non-HVAC objects and adhere to the following standards. The images are exported as transparent PNGs to maintain visual clarity. These images must meet an 8K UHD resolution (7680x4320 pixels) to ensure the highest level of detail. A monochrome color scheme (black and white) is applied to simplify the identification process. Within these images, HVAC objects are distinguished by a line thickness of 0.6mm, while other elements are represented with a 0.15mm thickness. The dimensions of each HVAC object are annotated in a textbox positioned directly next to the object. A reference node, designed as an equilateral triangle with dimensions of 500x500x500mm, is placed at a known coordinate or the origin of the CAD drawing. This reference node aids in the accurate calculation of the real image scale. Additionally, a selected list of the most common HVAC object types

is prepared. This list serves to enhance the accuracy of the proposed system by ensuring that the most relevant objects are identified and analyzed.

### 2.2 2D HVAC Drawing Extraction

#### 2.2.1 HVAC Object Detection

As mentioned earlier, the scarcity of 2D HVAC drawings available for training deep learning models in existing work presents a notable limitation. Additionally, many construction and architecture firms lack the requisite computational resources to deploy deep learning models effectively. To address these challenges, we have employed Suzuki's Contour tracing algorithm [10] in OpenCV library [1] to identify HVAC objects within the drawings and calculate their spatial coordinates.

Our analysis revealed that Ducts are the most critical objects within these drawings (see Table 1). Therefore, we focus on recognizing Ducts based on a list of common HVAC object types, proceeding to calculate their nine spatial coordinates. These coordinates include the four corner points, four midpoints, and the center point of the Ducts. The determination of the Ducts' direction is achieved by examining the mid-coordinates that intersect with other objects, facilitating the identification of continuous Ducts and their neighboring points along the presumed direction. In the case where a Duct is not continuous, and proximity to a reference point is established, the detection of other objects is guided by the following rule: a single nearest point plus space indicates an Elbow; two nearest points plus space suggest a Tee; and three nearest points plus space denote a Cross.

## 2.2.2 HVAC Object Dimension Estimation

To generate an accurate 3D model for a HVAC system, it is crucial not only to identify the type and location of each object but also to accurately estimate its dimensions. Initially, we employ the Suzuki's Contour algorithm to efficiently detect the bounding boxes of text areas. Subsequently, the cropping function in OpenCV is utilized to segment the image according to these boundary boxes. Then, PaddleOCR [2], an open-source library, is leveraged for text recognition on the segmented images. In the final step, we integrate detailed object dimensions with their respective types and locations to ensure the generation of highly accurate 3D models.

## 2.3 3D Model Generation

The purpose of our 3D generation module is to create a detailed and accurate 3D models based object information extracted in the 2D HVAC drawing extraction stage. The process leverages a two-step approach: (1) Parametric Model Definition: we utilize the extracted data to define key parameters of the 3D model, such as dimensions, shapes, orientations, and material properties. These parameters are established within a pre-defined parametric model, essentially serving as the building blocks for constructing the 3D geometry. (2) Automated Generation: to achieve full automation, we developed a tool named "Automation Scripts". Once the parameters are set, this script automatically generates the 3D model.

## 3 Results

We evaluate the effectiveness of our proposed AHMsys using a dataset of 2D CAD drawings collected from a BIM project at Akila in 2022. This dataset contains 63,629 HVAC objects from 110 CAD drawings. It has been determined that the most crucial object types in CAD drawings are Duct, Elbow and Tee, which collectively appear in nearly 86% of cases. The detailed statistics of our dataset are presented in Table 1.

# CAD drawings	# Objects	# Duct	# Elbow	# Tee	# Other
110	63,629	33,723	8,908	12,089	8,909

**Table 1.** Statistics of our experimental dataset. # stands for "Number of"

Table 2 presents the performance of AHMsys on our 2D CAD drawing dataset. As shown, the results demonstrate that the 3D models generated by AHMsys precisely represent the type, location, and dimensions of HVAC objects, achieving accuracy scores of 98.9%, 98.1%, and 98.4% respectively. Notably, AHMsys achieves an accuracy of over 98% when modeling Ducts, which are among the most popular and critical objects in the CAD drawings. These results and analysis are clear evidence of the effectiveness of AHMsys in performing the HVAC modeling process within BIM projects.

	Accuracy↑				
	Duct	Elbow	Tee	Other	All
Type of objects	99.6%	96.7%	99.2%	98%	98.9%
Location of objects	98.8%	95.1%	99%	97.3%	98.1%
Dimensions of objects	99.1%	95.8%	99.2%	97.2%	98.4%

**Table 2.** Performance of AHMsys on Akila's 2D CAD drawing dataset

Additionally, we present data on the workload (see Figure 3) and the project management report for the BIM project at Akila in 2022, which was deployed across three different cities: Shanghai, Chengdu, and Suzhou (see Table 3). It is clear that implementing our proposed AHMsys significantly reduced the work schedule by 20% compared to the estimated working hours when tasks were conducted entirely

manually by BIM engineers. These results highlight the effectiveness of AHMsys in automating the BIM process and enhancing the company's profitability.

## BIM Project Workload

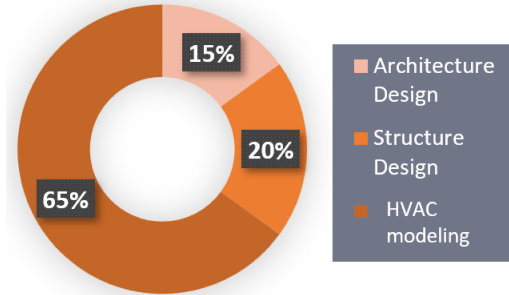

**Figure 3.** The workload for the BIM project at Akila Company in 2022 was mainly focused on HVAC modeling, which accounted for 65% of the total. The remainder was distributed among other disciplines, including architecture and structure design.

Cities	# BIM Engineers	Est. working hours	Actual working hours
Shanghai	3	773	626
Chengdu	4	707	552
Suzhou	3	309	253
All	10	1789	1431

**Table 3.** The project management report for the BIM project at Akila

## 4 Conclusion

In this paper, we develop a novel system named AHMsys that automatically generates 3D HVAC model from 2D drawing for BIM project. Our proposed AHMsys includes three main aspects, aiming at 2D Drawing Preprocessing, 2D HVAC Drawing Extraction, and 3D Model Generation, respectively. Notably, our proposed framework represents a completely novel and innovative approach within the construction domain, optimize processes traditionally performed by BIM engineers. Currently deploying at our company, Akila, it has significantly reduced the workload and production costs associated with BIM projects.

In the future, we aim to improve our automated HVAC modeling system by incorporating additional development frameworks. Moreover, we intend to expand the capabilities of our tool to manage more complex elements within buildings, such as piping and electrical components.

## References

- [1] G. Bradski. The OpenCV Library. *Dr. Dobb's Journal of Software Tools*, 2000.
- [2] Y. Du, C. Li, R. Guo, X. Yin, W. Liu, J. Zhou, Y. Bai, Z. Yu, Y. Yang, Q. Dang, and H. Wang. Pp-ocr: A practical ultra lightweight ocr system. *ArXiv, abs/2009.09941*, 2020. URL <https://api.semanticscholar.org/CorpusID:52986792>.
- [3] E. Elyan, C. F. Moreno-García, and C. Jayne. Symbols classification in engineering drawings. *2018 International Joint Conference on Neural Networks (IJCNN)*, pages 1–8, 2018. URL <https://api.semanticscholar.org/CorpusID:52986792>.
- [4] E. Elyan, L. Jamieson, and A. Ali-Gombe. Deep learning for symbols detection and classification in engineering drawings. *Neural networks : the official journal of the International Neural Network Society*, 129:91–102, 2020. URL <https://api.semanticscholar.org/CorpusID:219398260>.

- [5] L. Fu and L. B. Kara. From engineering diagrams to engineering models: Visual recognition and applications. *Comput. Aided Des.*, 43:278–292, 2011. URL <https://api.semanticscholar.org/CorpusID:17571580>.
- [6] G. Renton, P. Héroux, B. Gäüzère, and S. Adam. Graph neural network for symbol detection on document images. In *2019 International Conference on Document Analysis and Recognition Workshops (ICDARW)*, volume 1, pages 62–67, 2019. doi: 10.1109/ICDARW.2019.00016.
- [7] A. Rezvanifar, M. Cote, and A. B. Albu. Symbol spotting on digital architectural floor plans using a deep learning-based framework. *2020 IEEE/CVF Conference on Computer Vision and Pattern Recognition Workshops (CVPRW)*, pages 2419–2428, 2020. URL <https://api.semanticscholar.org/CorpusID:219177578>.
- [8] M. Rusiñol, J. Lladós, and G. Sánchez. Symbol spotting in vectorized technical drawings through a lookup table of region strings. *Pattern Analysis and Applications*, 13:321–331, 2010. URL <https://api.semanticscholar.org/CorpusID:13527378>.
- [9] S. Sarkar, P. K. Pandey, and S. Kar. Automatic detection and classification of symbols in engineering drawings. *ArXiv*, abs/2204.13277, 2022. URL <https://api.semanticscholar.org/CorpusID:248427021>.
- [10] S. Suzuki and K. Abe. Topological structural analysis of digitized binary images by border following. *Comput. Vis. Graph. Image Process.*, 30:32–46, 1985. URL <https://api.semanticscholar.org/CorpusID:205113350>.
- [11] I. C. Yılmaz, D. Yılmaz, O. Kandemir, H. Tekin, S. Atabay, and U. Bulut Karaca. Barriers to bim implementation in the hvac industry: An exploratory study. *Buildings*, 14(3), 2024. ISSN 2075-5309. doi: 10.3390/buildings14030788. URL <https://www.mdpi.com/2075-5309/14/3/788>.