



2010

Visit the Earl G. Maxwell Arboretum to view specimens of this year's Great Plants for the Great Plains selections.



1

Cladrastis kentuckea can be found at the northwest corner of the Plant Sciences building and the southeast corner of Kiesselbach

KEY

1

Cladrastis kentuckea
Yellowwood

2

Pinus cembra
Swiss Stone Pine

3

Aesculus parvifolia
Bottlebrush Buckeye

4

Eupatorium purpureum
'Gateway' Joe-pye Weed

5

Eragrostis trichodes
Sand Lovegrass



Frontage East

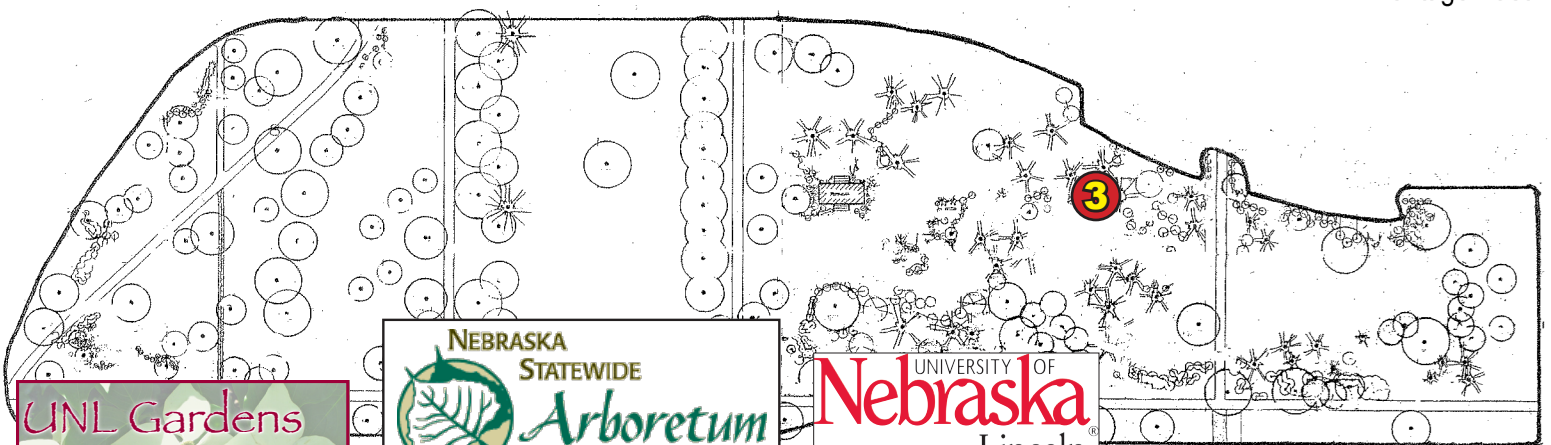

Frontage West

UNL Gardens



UNIVERSITY OF
Nebraska
Lincoln